

SHARP MANUFACTURING SYSTEMS CORPORATION

4-1-33, Atobehonmachi, Yao, Osaka 581-8581, Japan

Tel: (81)729-91-0682 / Fax: (81)729-91-0626

### Type of Notification: Model Name Change

ISSUE DATE	NOTIFICATION NO.	CHANGE TIMING	
2015/7/1	PCN- 20150701-01	2015/10/1	

*This is to advise you that the names of the following products have been changed.*

#### Product Category:

LCD Control Terminal, ZM500 Series

#### Product ID (Description):

NO.	MODEL NAME	DESCRIPTION
A	ZM-500 Series	LCD Control terminal, 18 kinds
B	ZM-540DU	Extension unit for ZM542
C	CU-xx Series	Communication Units (Made to order products)

#### Description of Change:

Due to unavailability of connectors, Sharp manufactures the above products with new connectors and changes the Model Names, accordingly.

#### Effect of Change:

The new connectors are not connectable with the old connectors. See the attachment for the details. Therefore, the old and new ZM500 Series models cannot be used in a mixed up manner.

#### New Model Names:

NO.	OLD MODEL NAME		NEW MODEL NAME	REMARKS
A. ZM-500 Series				
1	ZM-542DA	→	ZM-542DAN	"N" is added after the old Model Name.
2	ZM-542D	→	ZM-542DN	
3	ZM-542TA	→	ZM-542TAN	
4	ZM-542T	→	ZM-542TN	
5	ZM-562SA	→	ZM-562SAN	
6	ZM-562TA	→	ZM-562TAN	
7	ZM-562T	→	ZM-562TN	
8	ZM-571SA	→	ZM-571SAN	
9	ZM-571TA	→	ZM-571TAN	
10	ZM-571TL	→	ZM-571TLN	
11	ZM-572SA	→	ZM-572SAN	
12	ZM-572TA	→	ZM-572TAN	
13	ZM-573TA	→	ZM-573TAN	
14	ZM-573TL	→	ZM-573TLN	
15	ZM-581SA	→	ZM-581SAN	
16	ZM-582SA	→	ZM-582SAN	
17	ZM-583SA	→	ZM-583SAN	
18	ZM-591XA	→	ZM-591XAN	

**New Model Names: (Continued)**

NO.	OLD MODEL NAME		NEW MODEL NAME	REMARKS
B. Extension Unit for ZM542				
1	ZM-540DU	→	ZM-540DUN	"N" is added after the old Model Name.
C. Communication Units. CU-xx Series				
1	CU-00	→	CUN-00	"N" is added after "CU".
2	CU-01	→	CUN-01	
3	CU-02-2	→	CUN-02-2	
4	CU-03-3	→	CUN-03-3	
5	CU-04	→	CUN-04	
6	CU-06	→	CUN-06	
7	CU-07	→	CUN-07	
8	CU-08	→	CUN-08	

## ATTACHMENT

### About compatibility

1. Old models (having Model Name without "N") cannot be connected to new models (with "N") and vice versa because the connector shape is different.
2. The customers having ZM500 Main Units, ZM540DU and/or Communication Units, CU-xx, are requested to use them without mixing them up with the new models (with "N").

		Extension Unit for ZM542 / Communication Units	
		Old Models (without "N") ZM-540DU, CU-xx	New Models (with "N") ZM-540DUN, CUN-xx
ZM500 Main Units		Compatible	<b>Incompatible</b>
		<b>Incompatible</b>	Compatible

### Appearance Comparison

#### A. ZM500 Series Main Units

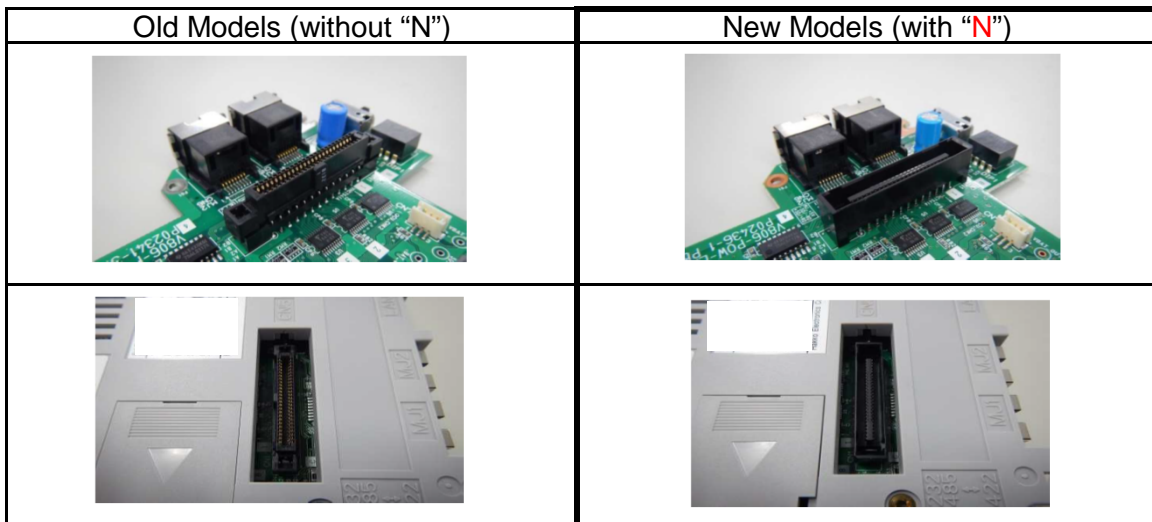

#### B. ZM-540DUx

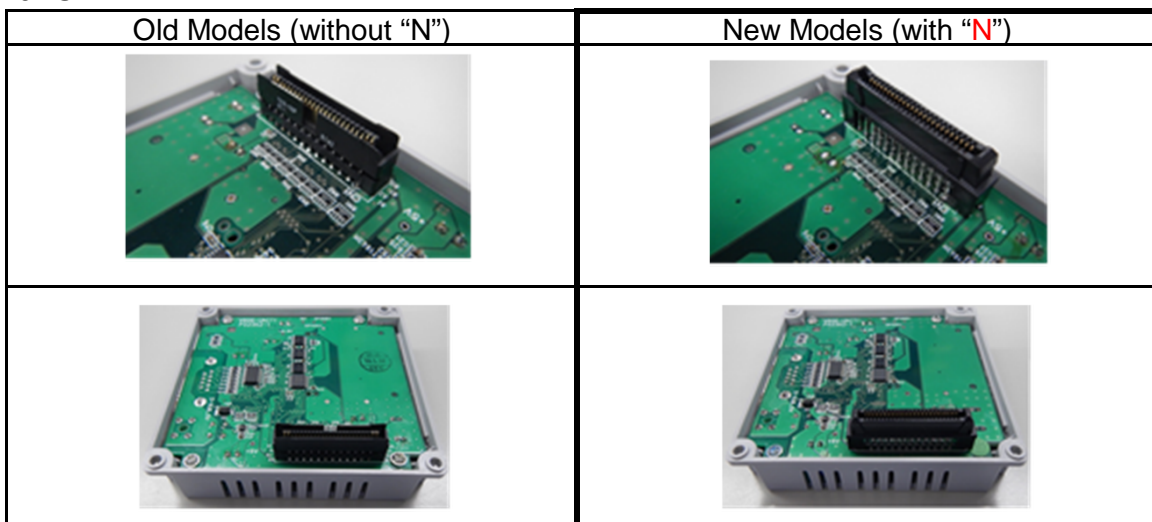

#### C. Communication Units. CU-xx Series

The connector is the same as that of ZM-540DUN.